



1.3

## Switch-disconnectors

■ ISOLATORS Series





# ISOLATORS Series

1

PLUGS AND SOCKETS



2

3

## SWITCH AND SWITCH-DISCONNECTORS



## VERSIONS



Surface mounting - Engineering plastic



Surface mounting - Metal

## REFERENCE STANDARDS

### EN 60947-3

Low voltage switchgear and controlgear.  
Part 3: switches, disconnectors, switch-disconnectors  
and fuse-combination unit.

## QUALITY MARKS



## TECHNICAL CHARACTERISTICS

Polarity:	<b>1P-2P-3P-4P</b>
Rated current:	<b>20A-32A-40A-63A-80A 100A-125A-160A</b>
Protection degree:	<b>IP55-IP65</b>
Operating temperature according to the reference standard:	<b>-5°C +40°C</b>
Max. operating temperature:	<b>60°C</b>
Glow Wire test:	<b>650°C</b>
Material:	<b>Engineering plastic/Metal</b>
IK degree at 20°C:	<b>Engineering plastic versions: 20A-32A-40A: IK07 63A-80A-100A: IK08</b>
Cable inlet:	<b>METRIC</b>
Colour:	<b>Grey RAL 7035 (Engineering plastic) Grey RAL 7015 (Metal)</b>

## ■ BEHAVIOUR WITH CHEMICAL AND ATMOSPHERIC AGENTS

Saline solution	Acids		Bases		Solvents				Mineral oil	UV rays
	Concentrated	Diluted	Concentrated	Diluted	Hexane	Benzol	Acetone	Alcohol		
Resistant	Limited Resistance	Resistant	Resistant	Resistant	Not Resistant	Not Resistant	Not Resistant	Limited Resistance	Resistant	Resistant

## ■ CABLE INLETS

### Engineering plastic versions

Enclosure 20A, 32A and 40A (82x120x69)

- Upper surface: 1xM20 + 1xM25
- Lower surface: 1xM20 + 1xM25
- Back surface: 2xM20

Enclosure 20A, 32A and 40A (136x125x84)

- Upper surface: 1xM20 + 1xM25
- Lower surface: 1xM20 + 1xM25

Enclosure 20A, 32A and 40A (105x150x82)

- Upper surface: 1xM20 + 1xM25
- Lower surface: 1xM20 + 1xM25

Enclosure 63A, 80A and 100A (210x155x107)

- Upper surface: 2xM25/M32
- Lower surface: 2xM25/M32

Enclosure 125A (300x220x120), and 160A (380x300x120)

- Blank side

### Metal versions

Enclosure 20A, 32A and 40A (105x150x82)

- Upper surface: 1xM20 + 1xM25
- Lower surface: 1xM20 + 1xM25

Enclosure 63A, 80A and 100A (150x210x106)

- Upper surface: 2xM32
- Lower surface: 2xM32

Enclosure 125A (315x264x122), and 160A (410x315x150)

- Blank side

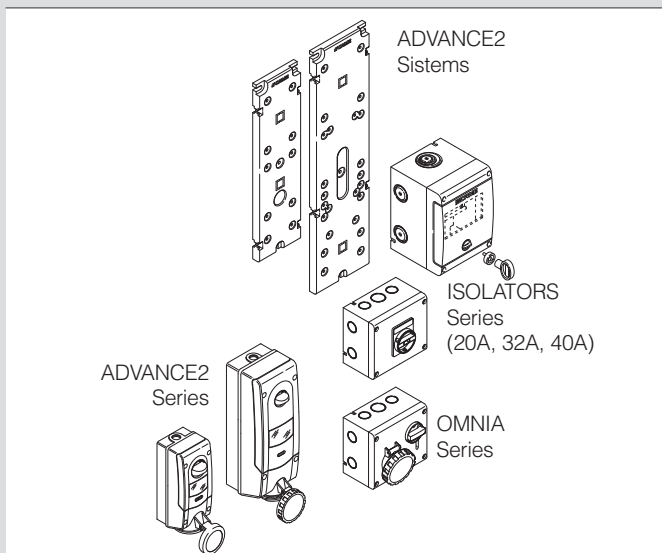

(The components shown above are modular with the engineering plastic version only)

# ISOLATORS Series

## Switch-disconnectors enclosed

### ■ THERMOPLASTIC INSULATED ENCLOSURE SWITCH DISCONNECTORS 2, 3, 3P+N AND 4 POLES - SURFACE MOUNTING 20A ÷ 40A

1  
PLUGS AND SOCKETS  
2  
3



				125x136x84 mm (*)	150x105x82 mm	210x155x107 mm	
				EMERGENCY SWITCHING	EMERGENCY SWITCHING	EMERGENCY SWITCHING	
				GENERAL USE	GENERAL USE	GENERAL USE	
	Poles	IP degree					
16A	6	IP65	1/5				
	8						
20A	2	IP65	1/12	590.EM2002	590.GE2002		
	3			590.EM2003	590.GE2003		
	3P+N			590.EM2005	590.GE2005		
	4			590.EM2004	590.GE2004		
	2				590.EM2012	590.GE2012	
	3				590.EM2013	590.GE2013	
	3P+N				590.EM2015	590.GE2015	
4		590.EM2014	590.GE2014				
25A	6	IP65	1/5	590.EM2506 590.GE2506			
	8			590.EM2508 590.GE2508			
	2			590.EM3202	590.GE3202		
	3			590.EM3203	590.GE3203		
32A	3P+N	IP65	1/12	590.EM3205	590.GE3205		
	4			590.EM3204	590.GE3204		
	2				590.EM3212	590.GE3212	
	3				590.EM3213	590.GE3213	
	3P+N				590.EM3215	590.GE3215	
	4				590.EM3214	590.GE3214	
	6				590.EM3206	590.GE3206	
8		590.EM3208	590.GE3208				
40A	2	IP65	1/12	590.EM4002	590.GE4002		
	3			590.EM4003	590.GE4003		
	3P+N			590.EM4005	590.GE4005		
	4			590.EM4004	590.GE4004		
40A	2	IP65	1/12	590.EM4012 590.GE4012			
	3			590.EM4013 590.GE4013			
	3P+N			590.EM4015 590.GE4015			
	4			590.EM4014 590.GE4014			
	6			590.EM4006 590.GE4006			
8	590.EM4008 590.GE4008						

Package/Bulk Pack  
 - 3P+N version with late break and early make neutral pole.  
 - 8 poles with late break and early make neutral poles.  
 - Equipped with door locking.

- (\*) Omnia series enclosure.  
 - Switch disconnectors units suitable as spare parts available in the general catalogue.  
 For 6 and 8 pole contact technical support.

## ■ THERMOPLASTIC INSULATED ENCLOSURE SWITCH DISCONNECTORS 2, 3, 3P+N AND 4 POLES - SURFACE MOUNTING 63A ÷ 160A

		210x155x107 mm		308x228x128 mm		338x308x128 mm	
Poles	IP degree	EMERGENCY SWITCHING	GENERAL USE	EMERGENCY SWITCHING	GENERAL USE	EMERGENCY SWITCHING	GENERAL USE
63A	2	590.EM6302	590.GE6302				
	3	590.EM6303	590.GE6303				
	3P+N	590.EM6305	590.GE6305				
	4	590.EM6304	590.GE6304				
	6			590.EM6306	590.GE6306		
	8			590.EM6308	590.GE6308		
80A	2	590.EM8002	590.GE8002				
	3	590.EM8003	590.GE8003				
	3P+N	590.EM8005	590.GE8005				
	4	590.EM8004	590.GE8004				
	6			590.EM8006	590.GE8006		
	8			590.EM8008	590.GE8008		
100A	3	590.EM10003	590.GE10003				
	3P+N	590.EM10005	590.GE10005				
	6			590.EM10006	590.GE10006		
	8			590.EM10008	590.GE10008		
125A	3	590.EM12503	590.GE12503				
	3P+N	590.EM12505	590.GE12505				
	6			590.EM12506	590.GE12506		
	8			590.EM12508	590.GE12508		
160A	3			590.EM16003	590.GE16003		
	3P+N			590.EM16005	590.GE16005		
	6			590.EM16006	590.GE16006		
	8			590.EM16008	590.GE16008		

Package/Bulk Pack

- 3P+N version with late break and early make neutral pole.
- 8 poles with late break and early make neutral poles.

- Equipped with door locking.

- Switch disconnectors units suitable as spare parts available in the general catalogue.

	Padlockable handle in one position ( <b>OFF</b> ).
	Padlockable handle in two positions ( <b>ON/OFF</b> ).
	<b>OFF</b> position = 3 padlocks
	<b>ON</b> position = 1 padlock

# ISOLATORS Series

## Switch-disconnectors enclosed

### ■ THERMOPLASTIC INSULATED ENCLOSURE SWITCH DISCONNECTORS 1 POLE - SURFACE MOUNTING 20A ÷ 40A

120x82x69 mm



GENERAL USE

	Poles	IP degree	□	
20A	1	IP65	1/12	<b>590.GE2021</b>
32A	1	IP65	1/12	<b>590.GE3221</b>
40A	1	IP65	1/12	<b>590.GE4021</b>

Suitable to switch single phase motor loads or other highly inductive loads (up to 40A 250V in AC 22A and 25A 250V in AC23A).

### ■ THERMOPLASTIC INSULATED ENCLOSURE SWITCH DISCONNECTORS 2, 3, 3P+N AND 4 POLES - FLUSH MOUNTING 20A ÷ 40A

125x136x107 mm



EMERGENCY SWITCHING GENERAL USE

	Poles	IP degree	□		
20A	2	IP65	1/12	<b>590.ER2002</b>	<b>590.GR2002</b>
	3			<b>590.ER2003</b>	<b>590.GR2003</b>
	3P+N			<b>590.ER2005</b>	<b>590.GR2005</b>
	4			<b>590.ER2004</b>	<b>590.GR2004</b>
32A	2	IP65	1/12	<b>590.ER3202</b>	<b>590.GR3202</b>
	3			<b>590.ER3203</b>	<b>590.GR3203</b>
	3P+N			<b>590.ER3205</b>	<b>590.GR3205</b>
	4			<b>590.ER3204</b>	<b>590.GR3204</b>
40A	2	IP65	1/12	<b>590.ER4002</b>	<b>590.GR4002</b>
	3			<b>590.ER4003</b>	<b>590.GR4003</b>
	3P+N			<b>590.ER4005</b>	<b>590.GR4005</b>
	4			<b>590.ER4004</b>	<b>590.GR4004</b>

### ■ FLUSH MOUNTING BOXES AND FRAME



Description	IP degree	Dimensions (mm)	□	
Flush mounting box	-	160x148x72	1/6	<b>572.0200</b>
Flush mounting box for plasterboard walls	-	150x139x75	1/6	<b>572.0205</b>
Flame complete with gasket	IP55	174x163x19	1/6	<b>572.0220</b>
Coupling insert	-	-	1/6	<b>572.0210</b>

□ Package/Bulk Pack  
- 3P+N version with late break and early make neutral pole.

- Switch disconnectors units suitable as spare parts available in the general catalogue.



**DOOR-LOCKING KIT**

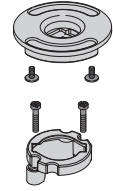

Description	Rotary switches		
Suitable for engineering plastic enclosure	20A, 32A, 40A	1/12	<b>590.BK040</b>
	63A, 80A	1/5	<b>590.BK080</b>
Suitable for metal enclosure	20A, 32A, 40A	1/12	<b>590.BK040H</b>
	63A, 80A	1/5	<b>590.BK080H</b>

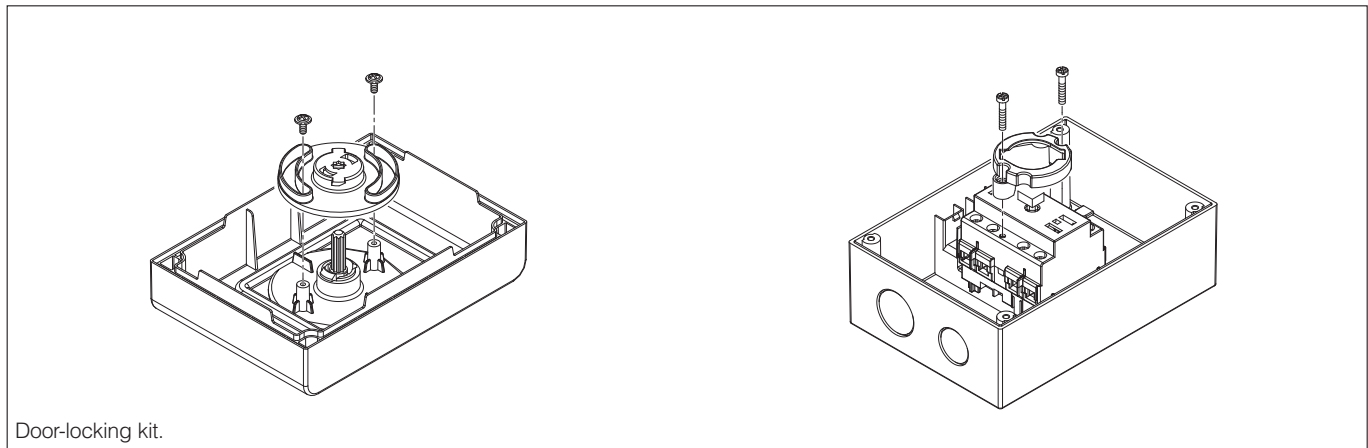

Door-locking kit.





# ISOLATORS Series

## Switch-disconnectors enclosed

### ■ ALLUMINIUM ENCLOSED SWITCH DISCONNECTORS 2, 3, 3P+N, 6 AND 8 POLES - SURFACE MOUNTING 16A ÷ 100A

1

PLUGS AND SOCKETS



2

3

150x105x82 mm

210x150x107 mm

315x264x122 mm











Poles	IP degree	□	150x105x82 mm		210x150x107 mm		315x264x122 mm				
			EMERGENCY SWITCHING	GENERAL USE	EMERGENCY SWITCHING	GENERAL USE	EMERGENCY SWITCHING	GENERAL USE			
16A	6	IP65	1/5			590.HEM1606	590.HGE1606				
	8					590.HEM1608	590.HGE1608				
20A	2	IP65	1/12	590.HEM2002	590.HGE2002						
	3			590.HEM2003	590.HGE2003						
	3P+N			590.HEM2005	590.HGE2005						
	4			590.HEM2004	590.HGE2004						
25A	6	IP65	1/5			590.HEM2506	590.HGE2506				
	8					590.HEM2508	590.HGE2508				
32A	2	IP65	1/12	590.HEM3202	590.HGE3202						
	3			590.HEM3203	590.HGE3203						
	3P+N			590.HEM3205	590.HGE3205						
	4			590.HEM3204	590.HGE3204						
40A	6	IP65	1/5			590.HEM3206	590.HGE3206				
	8					590.HEM3208	590.HGE3208				
	2			590.HEM4002	590.HGE4002						
	3			590.HEM4003	590.HGE4003						
63A	3P+N	IP65	1/5	590.HEM4005	590.HGE4005						
	4			590.HEM4004	590.HGE4004						
	6					590.HEM4006	590.HGE4006				
	8					590.HEM4008	590.HGE4008				
80A	2	IP65	1/5			590.HEM6302	590.HGE6302				
	3					590.HEM6303	590.HGE6303				
	3P+N					590.HEM6305	590.HGE6305				
	4					590.HEM6304	590.HGE6304				
100A	6	IP65	1/5			590.HEM6306	590.HGE6306	590.HGE6308			
	8					590.HEM6308	590.HGE6308	590.HGE6308			
	2					590.HEM8002	590.HGE8002				
	3					590.HEM8003	590.HGE8003				
100A	3P+N	IP65	1/5			590.HEM8005	590.HGE8005				
	4					590.HEM8004	590.HGE8004				
	6					590.HEM8006	590.HGE8006	590.HGE8008			
	8					590.HEM8008	590.HGE8008	590.HGE8008			
100A	3	IP65	1/5			590.HEM10003	590.HGE10003				
	3P+N					590.HEM10005	590.HGE10005				
	6					590.HEM10006	590.HGE10006	590.HGE10008			
	8	IP65	1/5			590.HEM10008	590.HGE10008				



□ Package/Bulk Pack

- 3P+N version with late break and early make neutral pole.
- 8 poles with late break and early make neutral poles.
- Equipped with door locking.

- Switch disconnectors units suitable as spare parts available in the general catalogue.

For 6 and 8 pole from 20 up to 40A contact technical support.

				315x264x122 mm		410x315x128 mm			
									
						 			
				EMERGENCY SWITCHING 		GENERAL USE 			
				EMERGENCY SWITCHING 		GENERAL USE 			
125A	3	IP65	1/5	590.HEM12503		590.HGE12503			
	3P+N			590.HEM12505		590.HGE12505			
	6					590.HEM12506		590.HGE12506	
	8	IP65	1/5			590.HEM12508		590.HGE12508	
160A	3	IP65	1			590.HEM16003		590.HGE16003	
	3P+N					590.HEM16005		590.HGE16005	
	6					590.HEM16006		590.HGE16006	
	8					590.HEM16008		590.HGE16008	

	Padlockable handle in one position ( <b>OFF</b> ).
	Padlockable handle in two positions ( <b>ON/OFF</b> ).
	<b>OFF</b> position = 3 padlocks
	<b>ON</b> position = 1 padlock



# ISOLATORS Series

## Switch-disconnectors enclosed

### DIMENSIONS

**1**  
**PLUGS AND SOCKETS**  
**2**  
**3**

**1 POLE 16A**

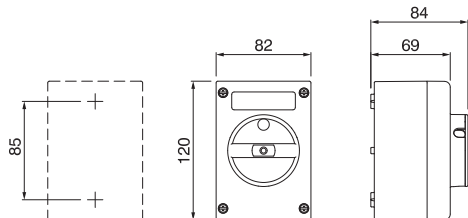

**2, 3, 4 POLES 20A, 32A, 40A**

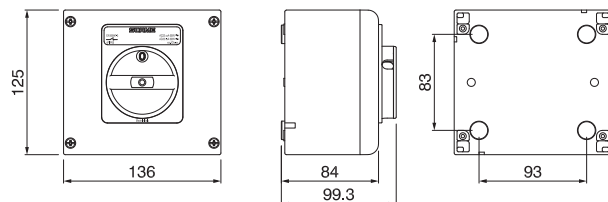

**2, 3, 4 POLES 20A, 32A, 40A**

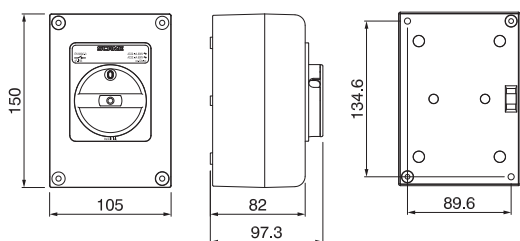

**2, 3, 4 POLES 63A, 80A, 100A**  
**6-8 POLES 16A, 25A, 32A, 40A**

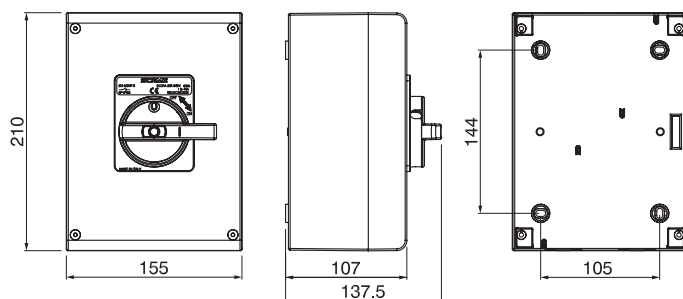

**4 POLES 125A**  
**6-8 POLES**  
**63A, 80A, 100A**

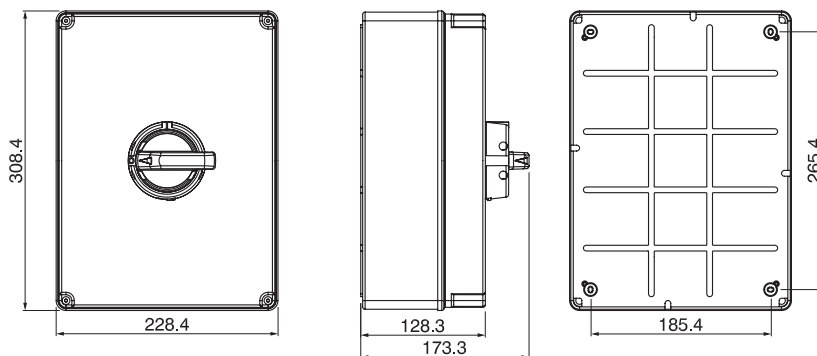

**3, 4 POLES 160A**  
**6-8 POLES**  
**125A, 160A**

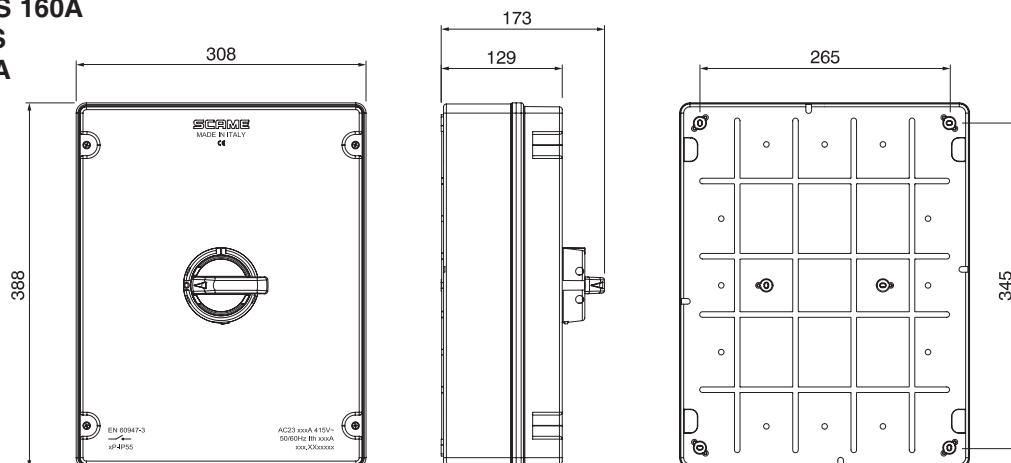

(Dimensions in mm)

**2, 3, 4 POLES 20A, 32A, 40A**

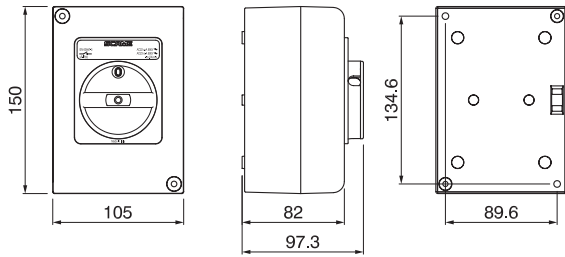

**2, 3, 4 POLES 63A, 80A, 100A  
6-8 POLES 16A, 25A, 32A, 40A**

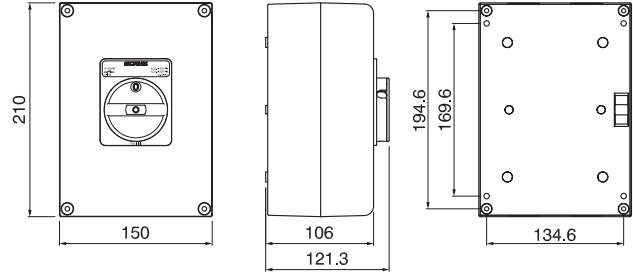

**4 POLES 125A / 6-8 POLES 63A, 80A, 100A**

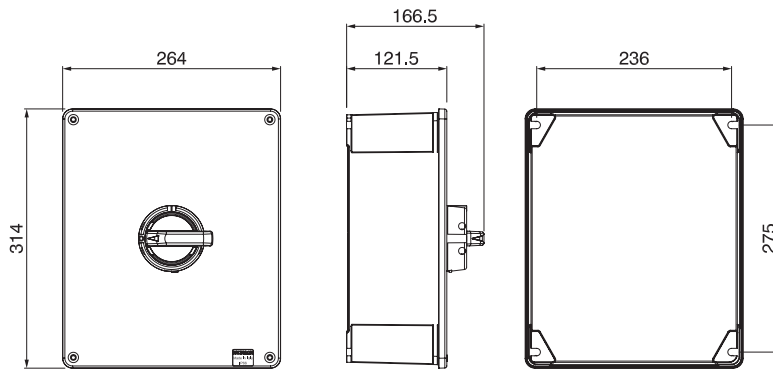

**3, 4 POLES 160A / 6-8 POLES 125A, 160A**

